

# PCE data sheet

article#	<b>10584-0wsc</b>
article description	<b>P-NOVA+ Safety socket nat.IP20 PCE 4hole</b>
description long	
GTIN (EAN)	9003399211324
country of origin	LK
customs number	85366990
net weight	0.034 kg
packaging quantity	100

ETIM 7.0	EC001325
Model	Protective contact (SCHUKO)
Material	Plastic
Material quality	Thermoplastic
Flange size	50x50 mm
With hinged lid	False
For heavy conditions (in accordance with VDE)	False
Degree of protection (IP)	IP20
Angle of plug	Straight
Connection system	Screwed terminal
Colour	White
Number of poles	3
Nominal current	16 A
Nominal voltage	250 V

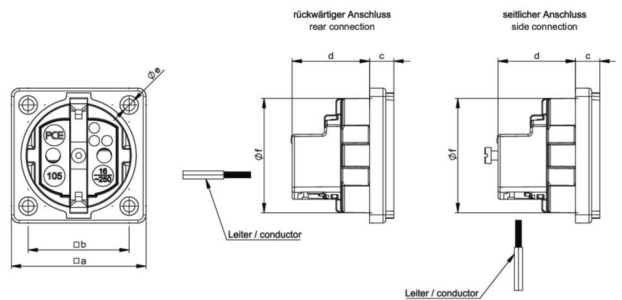

[www.manufacturer-safety.info](http://www.manufacturer-safety.info)

# Maßskizze / dimensional drawing

Benennung: Schutzkontaktsteckdose nach österr./deutsch. System IP20

description: Socket outlet Austrian/German system IP20

Teilenummer / part number: 10584-0\*

PCE

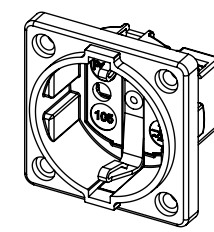
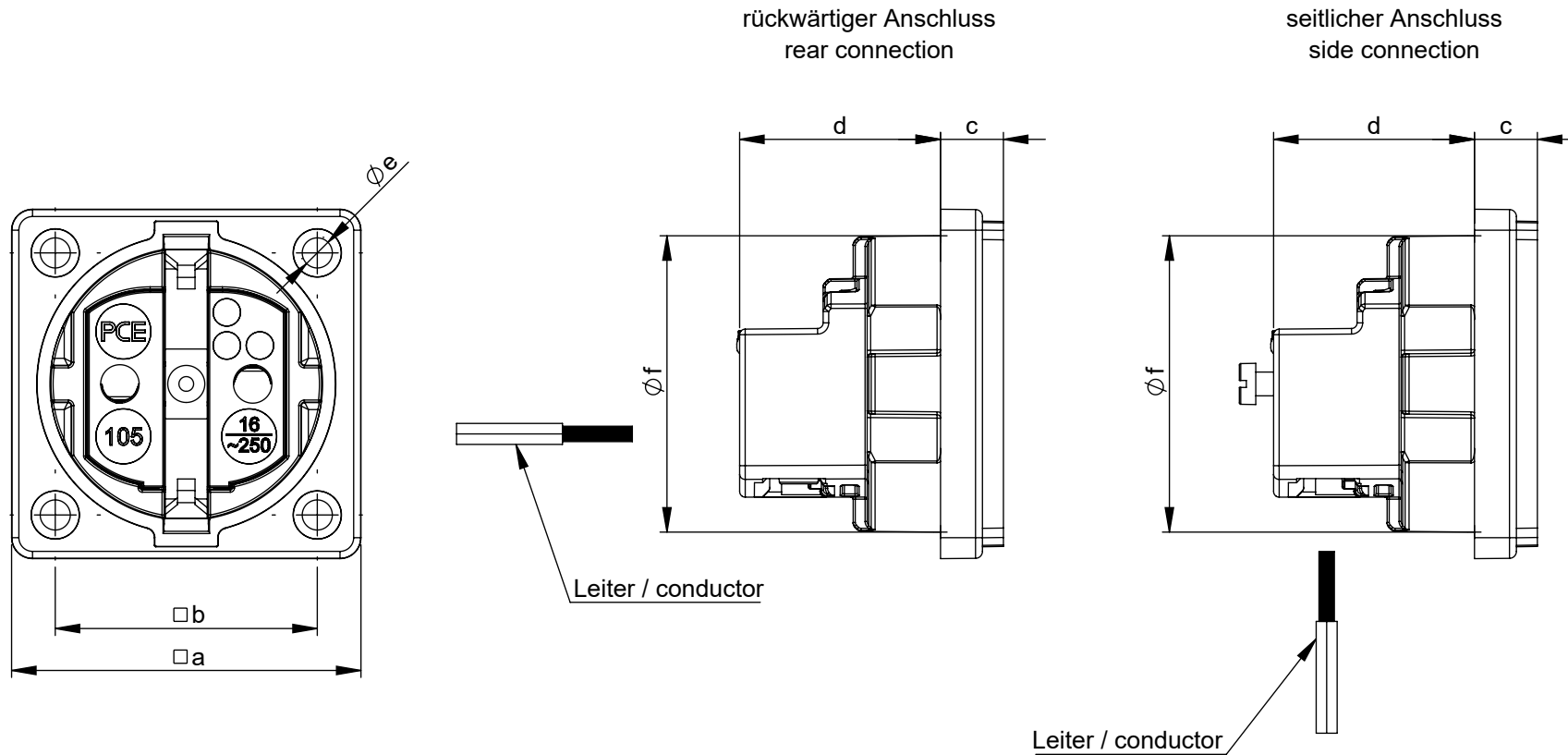

Ampere	16
Pole	2P+E
a [mm]	50
b [mm]	37,5
c [mm]	9
d [mm]	29
e [mm]	4,3
f [mm]	43