

GLASS SERIES

IP66 POLYESTER WALL-MOUNTING CABINETS

Description: IP66 POLYESTER WALL-MOUNTING CABINET 400x400x200 TRANSPARENT DOOR

Reference:
POL404020PT

Characteristics:

Product type:	Polyester wall-mounting cabinet
Dimensions cabinet:	(AxBxC) 400x400x200 mm
Installation:	Surface
Type of door:	Single transparent door
Locking:	Double-bit 3-mm DIN lock
Finish:	Double insulation: Class II
Colour:	RAL 7035
Mounting plate:	Without mounting plate
Weight (kg):	4,6
Materials:	Fibreglass-reinforced polyester
Thickness:	Enclosure 2,5 mm. Door 2,7 mm.
Sealing gasket:	Injected polyurethane sealing gasket
Door material:	UV stabilized polycarbonate
Capacity:	
Max. cabinet load:	32 kg
Max. mounting plate load:	26 kg
Max. door load:	

Technical data:

Degree of protection:	IP66
NEMA degree of protection:	
Resistance to impact:	IK08
Ambient temperature range:	-30 °C / +60 °C
Maximum operating voltage:	1000 V AC / 1500 V DC

Certificates and standards:

Directive:	2014/35/EU
Standards:	IEC 62208, IEC 61439-1
Certificates:	



Codes:

EAN:	8431044091273
Customs tariff number:	85.38.10.00
ETIM 8.0:	EC000261

GLASS SERIES

IP66 POLYESTER WALL-MOUNTING CABINETS

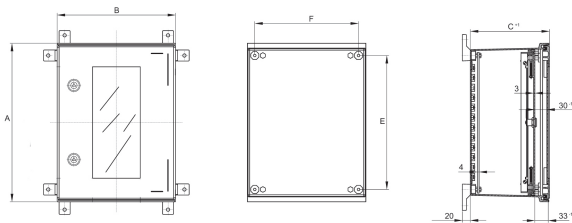

Description: IP66 POLYESTER WALL-MOUNTING CABINET 400x400x200 TRANSPARENT DOOR

Reference: POL404020PT



Standard drawing



Detailed drawing:  <http://www.ide.es/downloads/planos/pdf/POL404020PT.pdf>
 <http://www.ide.es/downloads/planos/dxf/POL404020PT.dxf>
 <http://www.ide.es/downloads/planos/stp/POL404020PT.stp>

Cable entry:	-	Body to be flush-fitted:	-
Wall fixing:	(ExF) 338x362 mm	Wall fixing material:	
Inside usable space:	(Height x Width) 362x363 mm	Glass door with transparent panel:	(HeightxWidth) 281x221 mm
No. Hinges:	2	Door profiles:	

Sustainability:

RoHS - REACH

Supply:

Supplied in individual packaging. The accessories for fitting the mounting plate are fitted on the cabinet. Plate supplied in individual packaging if requested as an accessory.

Product end of life:

It does not require specific recycling operations.

Recommended applications:

Industrial environments and outdoor facilities. food, chemical and pharmaceutical industries, transformer sub-stations and outdoor areas where durability and resistance against chemicals and UV rays are necessary.